

Window Integration

CASEMENT PI INFORMATION (DOUBLE GLAZED)

WITH MULTI-POINT HANDLE

*MIN DIMENSIONS 16" x 16" [406 x 406]

*MAX DIMENSIONS 36" x 62" [914 x 1575] or 27" x 84" [686 x 2134]

SCREEN OPTION

MAX OPENING 105°

LIMITED OPENING OPTION @ 4" [102]

CUSTODIAL HANDLE OPTION

EGRESS OPTION

**Based on (DLO) dimensions, Dimensions in brackets are in [mm] millimeters*

Curtain Wall Integration

Storefront Integration

1

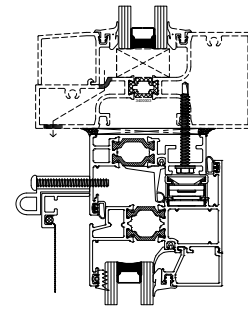
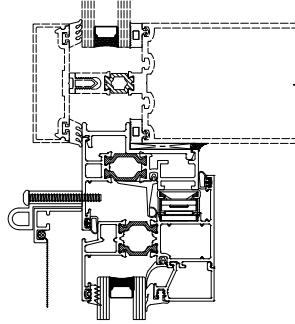
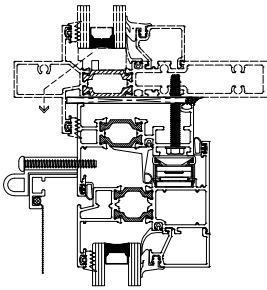

2

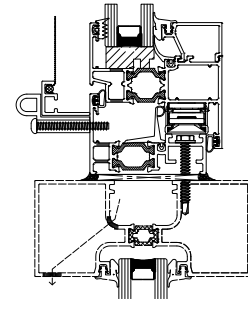
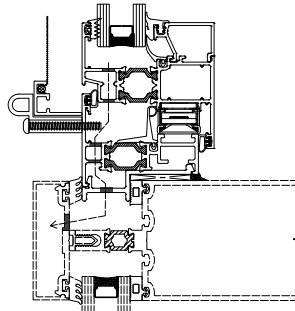
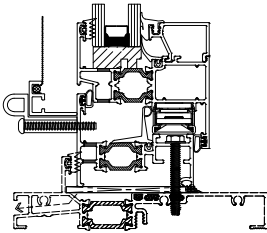

3

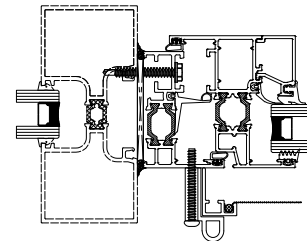
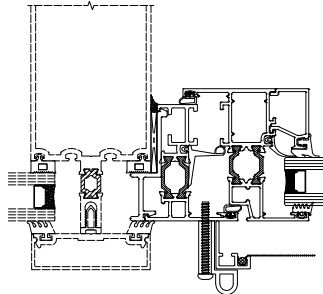
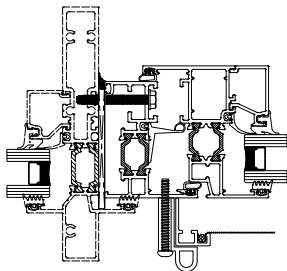

4

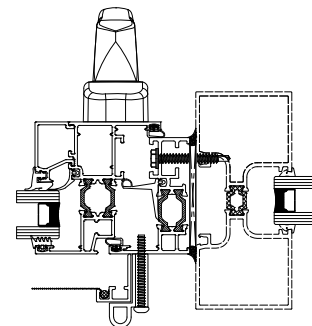
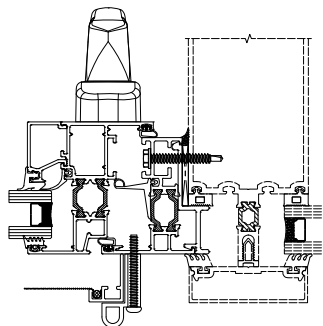
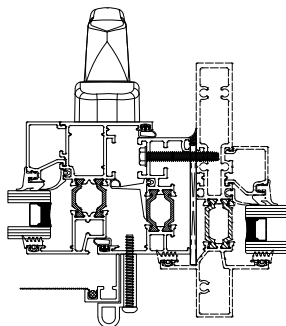

**CASEMENT PROJECT IN WITH MULTI-POINT LOCKING HANDLE
(Double Glazed)**

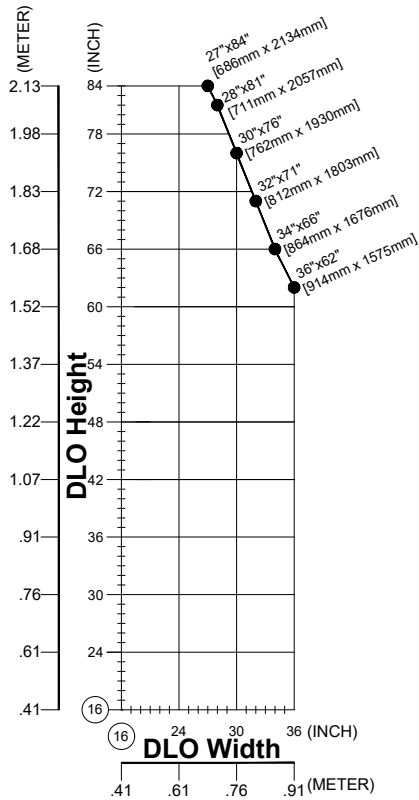

MPL HANDLE



OPTIONAL CUSTODIAL LOCK WITH REMOVABLE MAINTENANCE WRENCH

MPL casement hardware includes the following:

- MPL handle available in Silver, White, or Black finish
- One multipoint locking handle centered on the sash jamb
- One pair of concealed hinges
- Snubber set (as required)
- Glass stop for 1 3/4" (44.4 mm) glazing
- Interior glazing spline

Optional extras (must be specified at time of ordering or quotation):

- Insect screen (fiberglass or aluminum mesh)
- Custodial lock with removable maintenance wrench
- Sash limiters
- Hardware other than standard
- Glazing gasket for 1 1/16" [27mm] IGU

Charts are based upon an insulating glass unit infill of 1" [25.4mm] overall thickness comprised of 6mm glass/13mm gas fill/6mm glass

Using this chart: Ensure your largest maximum size falls within the above size limitation chart